

FURNISHED OFFICE SPACE FOR LEASE

Century Building

For more
information
or to
schedule
a showing
please contact
Tony or Tim.



ADDRESS

9750 E. 50th St. N., Bel Aire, KS
(Webb Rd. & 50th)
Near K-96 Expressway

SPACE AVAILABLE

1,285 sq. ft.

TERM

3-5 years preferred

RENT

\$2,000 per month (\$18.67 psf)
Full-Service Lease

COMMENTS

- Seven furnished offices and reception area
- Building conference room and breakroom
- Doorside parking
- Exterior entrance to leased premises
- On-site ownership and management
- Building signage available



Tony Utter: 316-990-8710 (mobile) / 316-263-2448 (office)
CCIM, JD tony@utterproperties.com

Tim Utter: 316-871-1628 (mobile) / 316-263-2448 (office)
tim@utterproperties.com

9750 E 50th St N / Floor Plan

For more
information
or to
schedule
a showing
please contact
Tony or Tim.

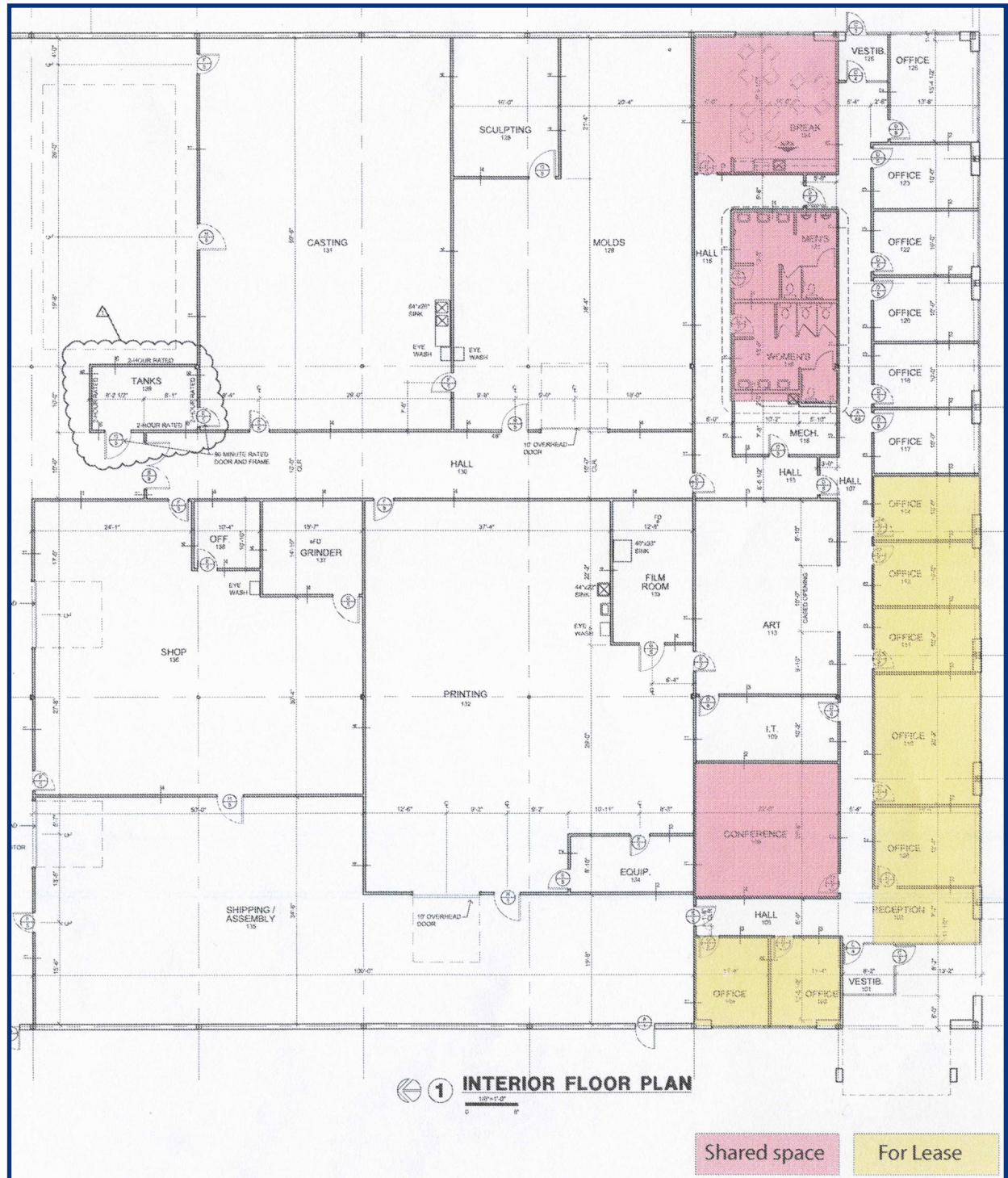

Tony Utter: 316-990-8710 (mobile) / 316-263-2448 (office)
CCIM, JD tony@utterproperties.com

Tim Utter: 316-871-1628 (mobile) / 316-263-2448 (office)
tim@utterproperties.com

The information contained herein was obtained from sources believed reliable, however, Utter Commercial Real Estate, Inc. makes no guarantees, warranties or representations as to the completeness or accuracy thereof. The presentation of this property is submitted subject to errors, omissions, change of price or conditions prior to lease, or withdrawal without notice.